

# SMX25L, SMX16L & SMX10L PARTS LIST

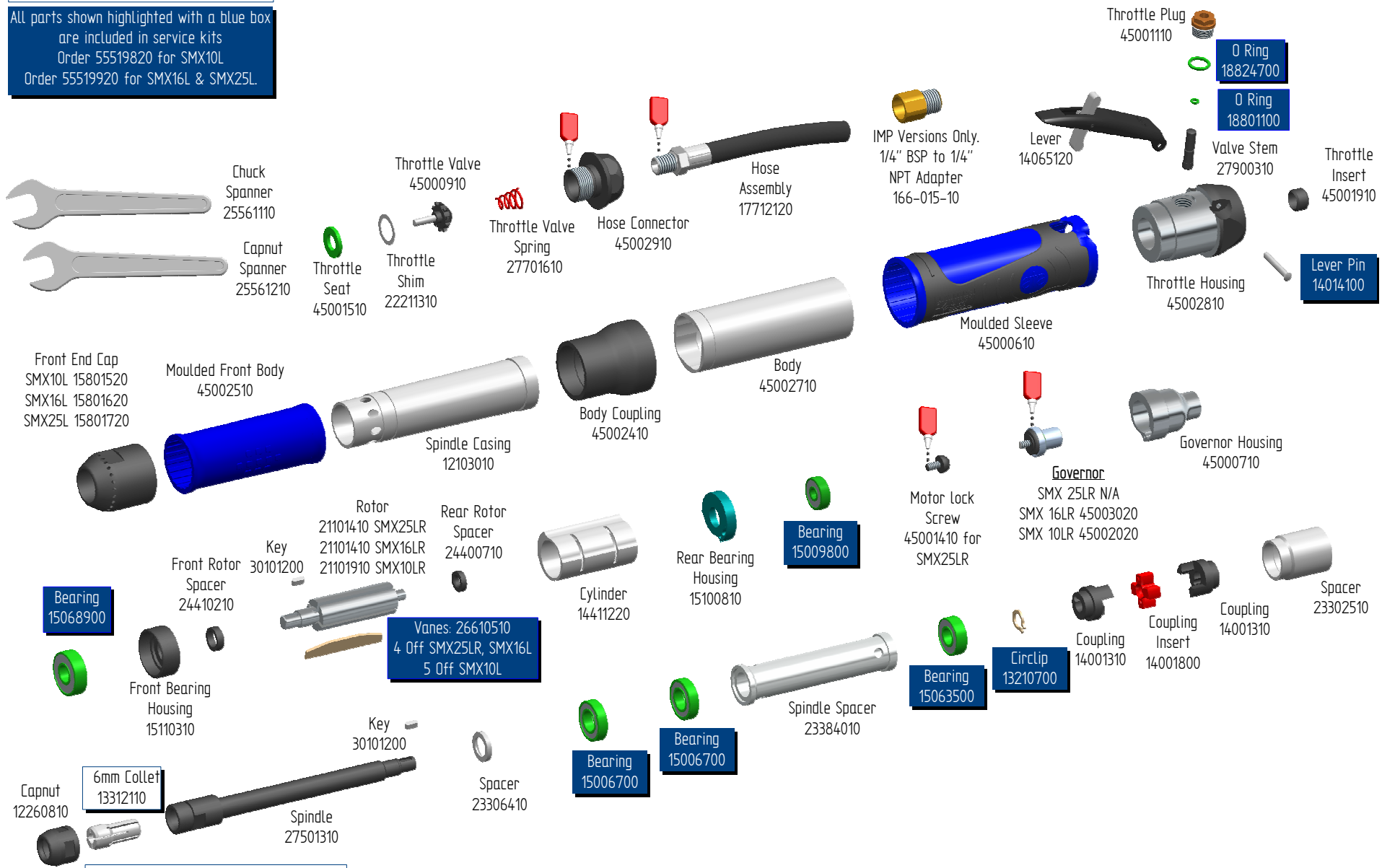

## MOTOR SERVICE KIT

All parts shown highlighted with a blue box are included in service kits  
 Order 55519820 for SMX10L  
 Order 55519920 for SMX16L & SMX25L.



Also Available			
8mm	13312410	1/4"	13310710
10mm	13310610	3/8"	13312510
		1/8-3mm"	13312310

Parts Diagram, 990-226-10 Issue No 030119

This Symbol indicates 242 Loctite Required

MODEL	RPM	m <sup>3</sup> /min	kg	dB(A)	m/s <sup>2</sup>
<b>SMX25L</b>	<b>25000 RPM</b>	<b>0.62</b>	<b>1.30</b>	<b>78</b>	<b>&lt;2.5</b>
<b>SMX16L</b>	<b>16000 RPM</b>	<b>0.62</b>	<b>1.30</b>	<b>77</b>	<b>&lt;2.5</b>
<b>SMX10L</b>	<b>10000 RPM</b>	<b>0.62</b>	<b>1.30</b>	<b>74</b>	<b>&lt;2.5</b>