

SHG18LR PARTS LIST

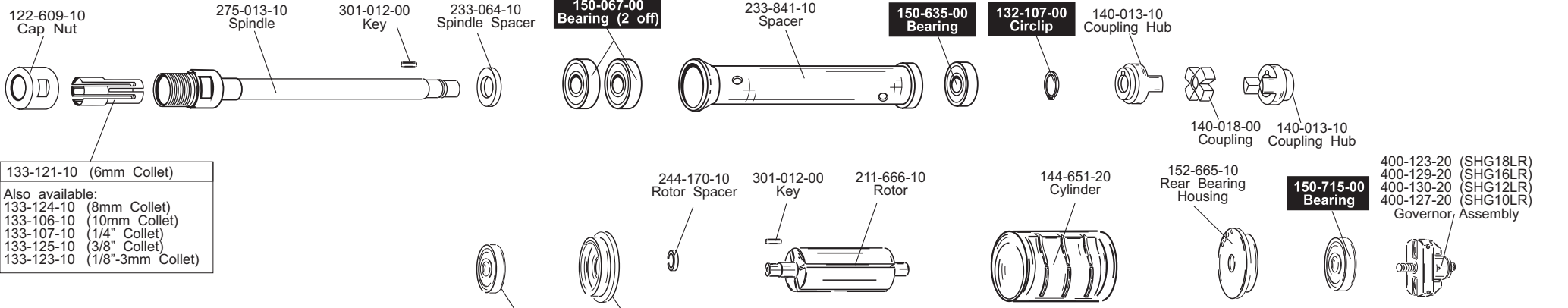

990-210-10 100111



133-121-10 (6mm Collet)
Also available:
133-124-10 (8mm Collet)
133-106-10 (10mm Collet)
133-107-10 (1/4" Collet)
133-125-10 (3/8" Collet)
133-123-10 (1/8"-3mm Collet)

MOTOR SERVICE KIT
All parts shown highlighted with a black box are included in SERVICE KIT 555-149-20

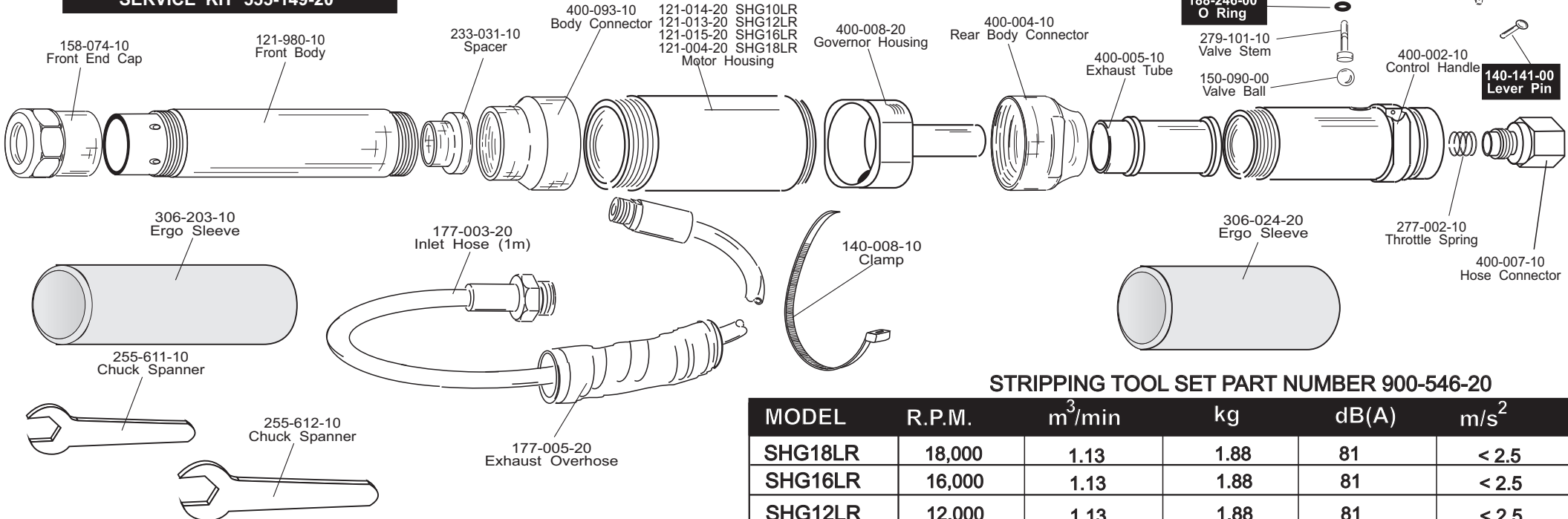

STRIPPING TOOL SET PART NUMBER 900-546-20

| MODEL | R.P.M. | m ³ /min | kg | dB(A) | m/s ² |
|---------|--------|---------------------|------|-------|------------------|
| SHG18LR | 18,000 | 1.13 | 1.88 | 81 | < 2.5 |
| SHG16LR | 16,000 | 1.13 | 1.88 | 81 | < 2.5 |
| SHG12LR | 12,000 | 1.13 | 1.88 | 81 | < 2.5 |
| SHG10LR | 10,000 | 1.13 | 1.88 | 81 | < 2.5 |